

Installation Tips

Batten distance (MULTI ROOF)

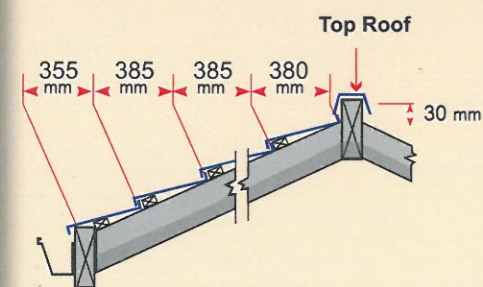

How to instal lisplank (MULTI ROOF)

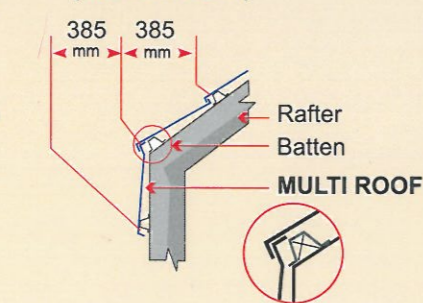

How to nail the tile

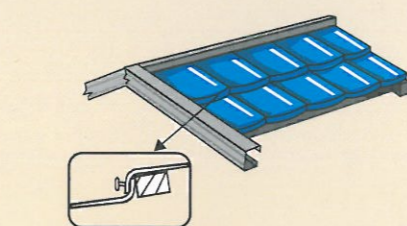

Chamfer installation

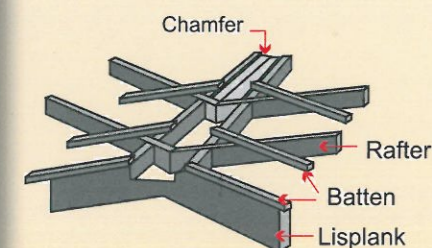

Wall interface

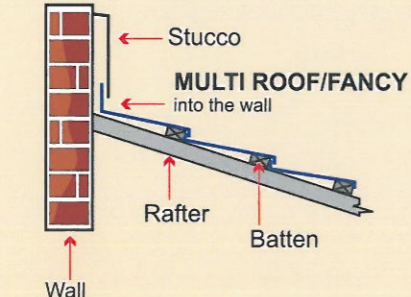

Flat dan wall interface

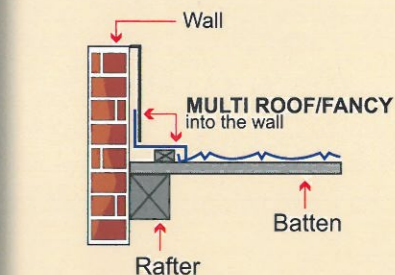

Installation of roof edge

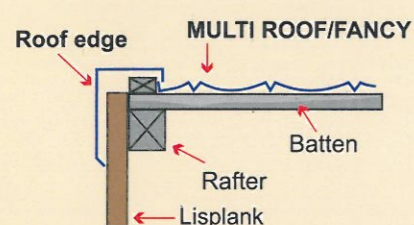

Roof Top



Roof Edge



Round Roof Top

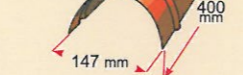

Wall Flashing

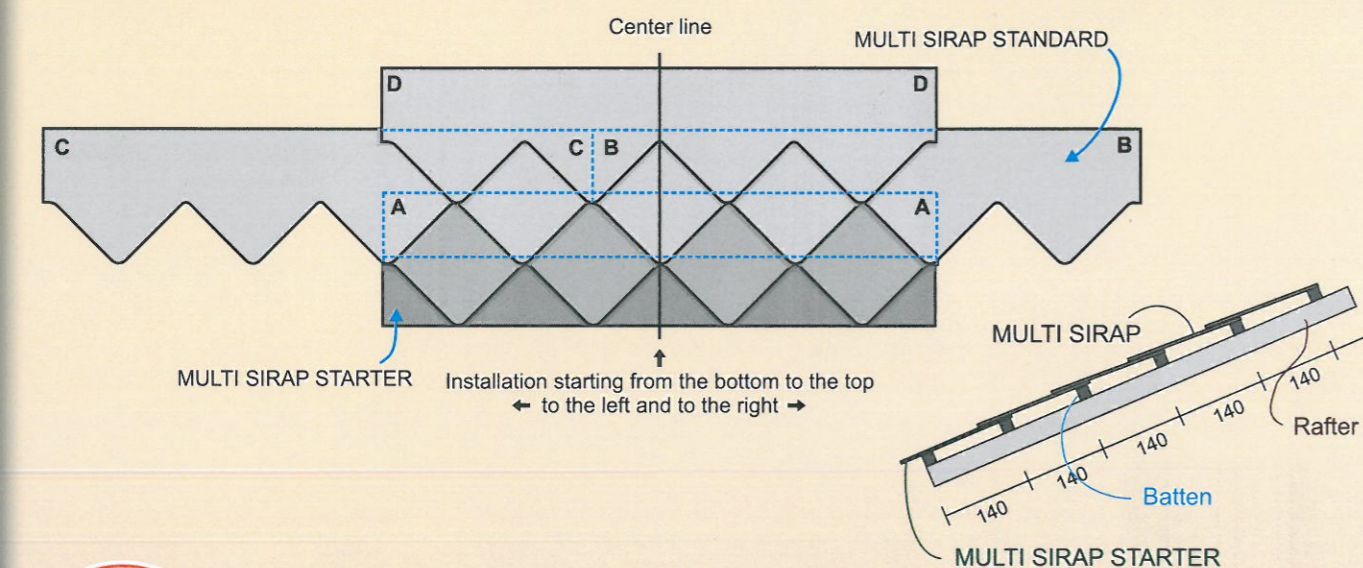
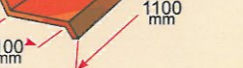

MULTI ROOF

GRANULAR STEEL ROOF TILES



Bring
A Tropical Feel
to Your Home



www.tatalogam.com



Metal tile MULTI ROOF, MULTI SIRAP and FANCY using stamping system with progressive dies that produce metal roof with beautiful shape and compact with high accuracy.

Zinc-aluminium material is strong and corrosion resistant, producing tiles that are solid and highly resistant to load and impact.

Plus the natural stone coating process using adhesives and protective high-quality, MULTI ROOF tiles are tested as durable and resistant to weather changes.

Natural stone layer in addition to providing beauty, also serves to reduce heat and noise.

**CORROSION
RESISTANCE**

**SPLITS
PROOF**

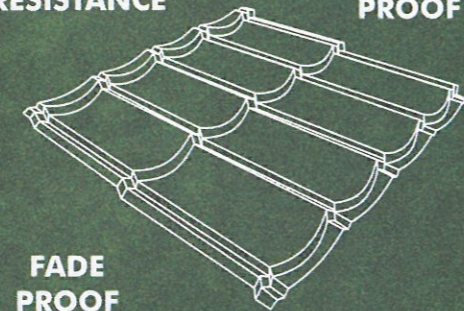

**FADE
PROOF**

**ANTI MOSS
AND FUNGI**

The coating composition of STONE SERIES

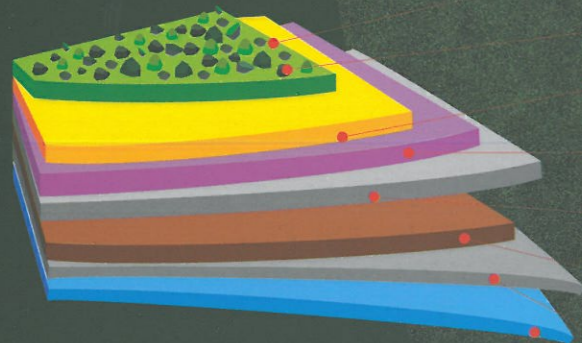

- **ACRYLIC OVERGLASS:**
Glossy transparent layer (glaze), anti moss and dust resistant
- **STONE CHIPS:**
- **ACRYLIC BASE COAT:**
High quality adhesive material
- **EPOXY PRIMER:** Add adhesion between Zinc-Aluminium Coated with following layer
- **ZINC-ALUMINIUM COATED:**
using G300 zinc-Aluminium accordance with US Standard 1397
- **BASE METAL**
Using the base metal / steel according to Standard JIS. G. 3141
- **ZINC ALUMINIUM COATED**
- **EPOXY PRIMER**

Note:

This brochure printing process may result in the difference between the color of tile on the brochure to the original. The original color of the product can be seen in product samples found at the distributors/stores nearby.

MULTI ROOF



Model
Classic

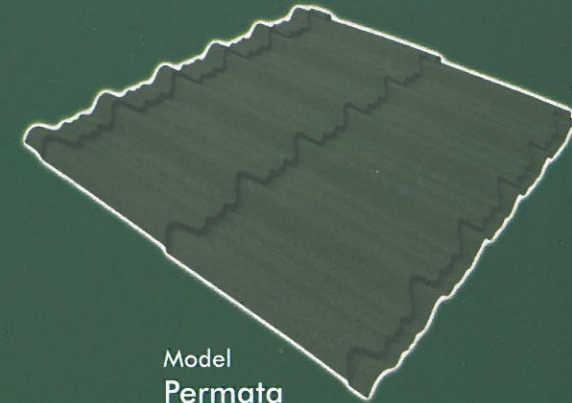

Model
Permata

Model	Sheet	1 meter square	Effective width	Effective length	Battens Distance	Rafter Distance
Classic Permata	2 x 5 (10 leafs)	1,30 1,48 sheet	1.000 875 mm	770 mm	385 mm	500 mm

Pretty Maroon

Jade Green

Coffe Brown

Diamond Black

Stone Grey

Beautiful Amber

Available color:

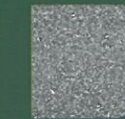

Fancy®



Sheet	Coverage per sheet	Effective width	Effective length	Battens Distance	Rafter Distance
1 stack	0,283 meter ²	1,010 mm	280 mm	280 mm	500 mm
2 stacks	0,565 meter ²	1,010 mm	560 mm		

MULTI SIRAP®

Borneo		Dwipa	
Forest Green	Sand Beach Grey	Tropical Maroon	

Specification	Borneo	Dwipa
Dimensions (mm)	7000 x 345	7000 x 364
Exposure (mm)	180	140
Weight per m2 (kg)	6,6	9
Elevation	12°- 90°	12°- 90°
Battens Size(mm)	20 x 30	20 x 30
Rafter Size (mm)	50 x 70	50 x 70
Battens Distance (mm)	120	120
Rafter Distance (mm)	500	500

